



SMARTPOWER™ Mini Detergent & Rinse

Experience outstanding cleaning performance and stain removal with the mini and mighty SMARTPOWER™ Mini Detergent & Rinse. SMARTPOWER™ Mini delivers all the brilliance of SMARTPOWER™ for smaller spaces.

Designed to transform undercounter dishwashers with a safe and efficient off-the-floor approach, our compact 2-in-1 pressed detergent and rinse aid solution ensures unparalleled cleanliness first time, every time. It is the ultimate space-saving solution for your undercounter machine - compact, efficient, and powerful.



Effective on all dishware



2-in-1 concentrated formula



Smart, small, simple, safe & sustainable



93% reduction in packaging waste



NTA-, EDTA-, chlorine-, phosphate- and phosphonate-free formula



Recognised Environmental Credentials Scheme by Accord



CLEANER. SAFER. HEALTHIER

ECOLAB®

SMARTPOWER™ Mini Detergent & Rinse

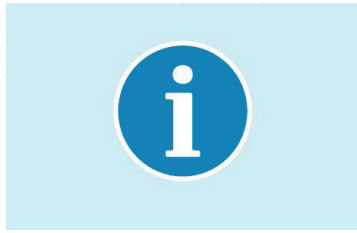

1. Check hygiene plan and product label for detailed use information.

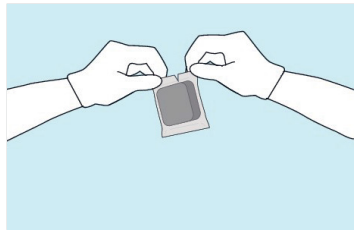

2. Take one block and open the plastic foil.

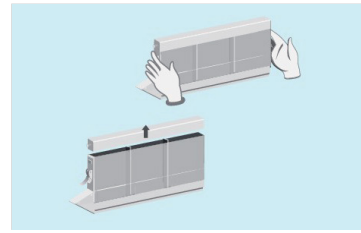

3. Open lid of dispenser on both sides.

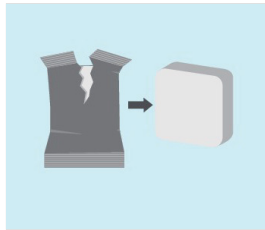

4. Remove foil from block.

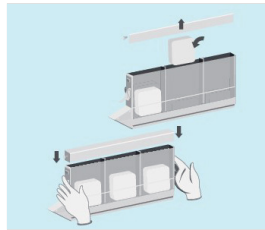

5. Insert 3 blocks to dispenser and close the lid on both sides.

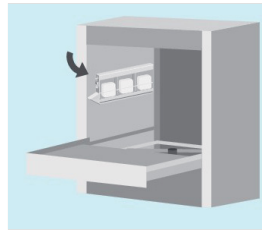

6. Place dispenser into holder.

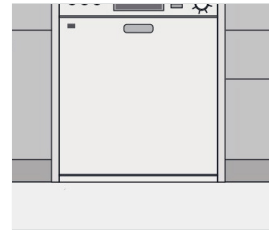

7. Let the machine run in the long program once, then wash in standard program.

Important Notes

- Before descaling always remove the SMARTPOWER™ Mini dispenser from the dishmachine, empty the wash tank and fill the machine with fresh water.
- Only for use with Ecolab SMARTPOWER™ Mini dispenser. Your Ecolab specialist will adjust the dosing system to your specific cleaning needs.
- For professional use only.

Safety Information

Do not mix with any other product

For more information, please refer to the safety data sheet

Pack Size & Code

24x135g 9113360

Dispenser (1pc) 10241334

Scan the QR code below to view the Digital Safety Data Sheet (SDS)



Australia



New Zealand

ECOLAB®

AUSTRALIA
6 Giffnock Avenue
Macquarie Park
NSW, 2113
T: 02 8870 8100

NEW ZEALAND
2 Daniel Place
Te Rapa
Hamilton, 3241
T: 0508 732 733

FIJI
Lot 1 W&G Industrial
Estate, Marine Drive
Wailekutu, Lami
T: (+679) 3361 744