

# PW1C

FRONTLOADING WAREWASHER  
C/W HEAT RECOVERY UNIT

**STARLINE**  
by **WASHTECH**



## STANDARD FEATURES

Integrated Heat Recovery Unit  
No external extraction canopy required\*  
Recycles energy from steam to heat incoming water  
Customisable 2, 4, and 6 minute cycles  
Touchscreen controls  
Front loading chamber with W720 x D600 x H750 capacity  
2.0HP wash pump  
Dual chemical pumps  
Assured rinse plus rinse pump  
Hands-free drainage system with sump and drain pump  
Two-stage stainless steel wash and drain filtration  
Heavy-duty stainless-steel construction and manifold  
Independent stainless-steel wash and rinse arms

2x 500mm dish rack (600 70028)  
1x 500mm cup rack (600 70029)  
1x cutlery container (C660503)  
1x plumbing connection kit (water and chemical hoses)

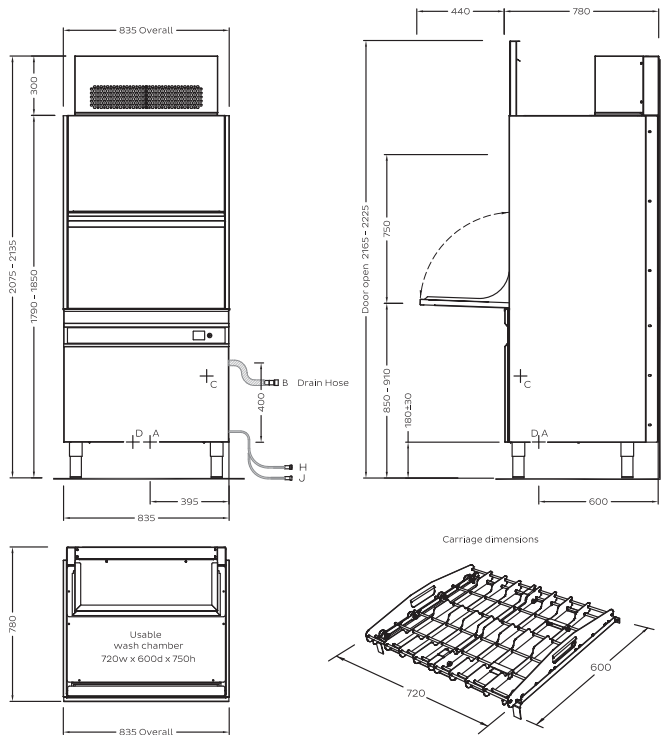

## SPECIFICATIONS

<b>A - Hot Water</b> (fill only)	Temperature 65°C
<b>D - Cold Water</b>	Temperature <25°C
Connection	3/4" male, hose supplied
Pressure	100-350kPa**
Flow	10L per minute
Backflow prevention	Atmospheric vacuum breaker
Consumption	2.4L (cold) per cycle

### B - Drainage

Drain pump flexi-hose 25mm

C - Electrical	V	Hz	A/ph	Max kW
Three phase	400 - 415	50	15	10.50
Three phase	400 - 415	50	25	18.00

### Dimensions

	Machine	Packed
Width (mm)	835	1000
Depth (mm)	780	910
Height (mm)	2075	2090
Weight (kg)	186	209
Volume (m3)		1.8

### Water Quality

	Min	Max
pH	7	8
TDS (ppm)	1	135
Hardness		100
Cl-		100
SO4		400
Fe		0.1
Cl2		0.1

\*Subject to adequate general ventilation. Full details and certification from SEED available on request.

\*\*Suitable for connection to low flow water supplies.  
Isolating switch must be within 1m of, and not directly behind, the machine  
Refer to operator manual for installation instructions

In line with policy to continually develop and improve its products, Washtech reserves the right to change specifications and design without notice.

an Ali Group Company



the spirit of excellence