

M1C

COMPACT PASSTHROUGH DISHWASHER
C/W HEAT RECOVERY UNIT

STARLINE
by **WASHTECH**



STANDARD FEATURES

Integrated Heat Recovery Unit
No external extraction canopy required*
Recycles energy from steam to heat incoming water
60, 120 and 180 second cycles - up to 840 plates per hour
Touchscreen controls with versatile Heads Up Display
2.4L per cycle water consumption
Compatible with 450mm racks
Suitable for 600mm-700mm bench depth
1.0HP soft start wash pump
Dual chemical pumps
Assured rinse with booster pump
Hands-free drainage system with sump and drain pump
Two-stage stainless steel wash and drain filtration
Heavy-duty stainless-steel construction and manifold
Independent stainless-steel wash and rinse arms
2x 450mm dish rack (600 70081)
1x 450mm cup rack (600 70080)
1x cutlery container (C660503)

SPECIFICATIONS

D - Cold Water

Temperature	<25°C
Connection	3/4" male, hose supplied
Pressure	100-500kPa
Flow	10L per minute**
Backflow prevention	Atmospheric vacuum breaker
Consumption	2.4L per cycle

B - Drainage

Drain pump flexi-hose	25mm
-----------------------	------

C - Electrical

V	Hz	A/ph	Max kW
Three phase 400-415	50	15	9.00***

*Subject to adequate general ventilation. Full details and certification from SEED available on request.

**Suitable for connection to low flow water supplies.

***Single phase options possible although require modification by a Technician and will impact recovery time between cycles.

Isolating switch must be within 1m of, and not directly behind, the machine. Refer to operator manual for installation instructions.

In line with policy to continually develop and improve its products, Washtech reserves the right to change specifications and design without notice.

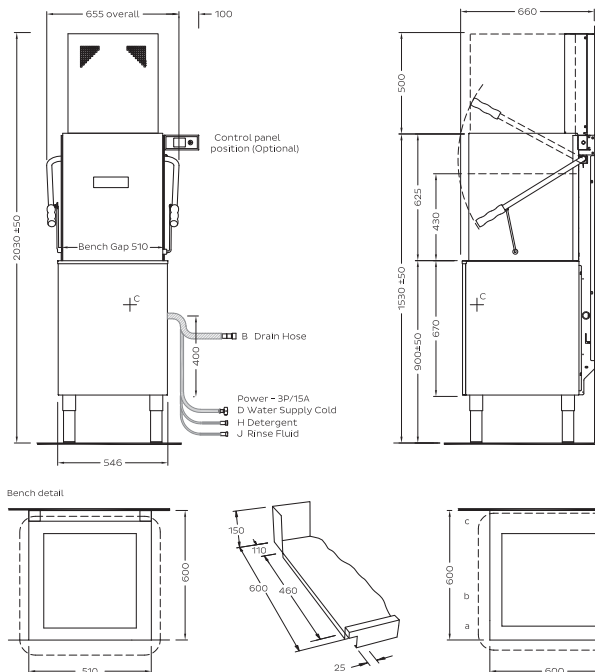

Dimensions

	Machine	Packed
Width (mm)	655	695
Depth (mm)	660	750
Height (mm)	2030	1970
Weight (kg)	80	101
Volume (m3)		1.03

Water Quality

	Min	Max
pH	7	8
Hardness	20	100
Cl-		100
SO4		400
Fe		0.1
Mn		0.5
Cu		0.05
Cl2		0.1

Corner Installation Notes:

- Machine should be installed so racks are pushed into the back of the machine.
- Allow 300mm clearance to front for service access.
- Splashback return to be no higher than 150mm.

Touchscreen Control:

- Bracket supplied with controls enables install either side, under bench or on wall.
- Consult Operator Manual for full details on correct installation.

an Ali Group Company



the spirit of excellence