

Citrus Juicer Operation Manual

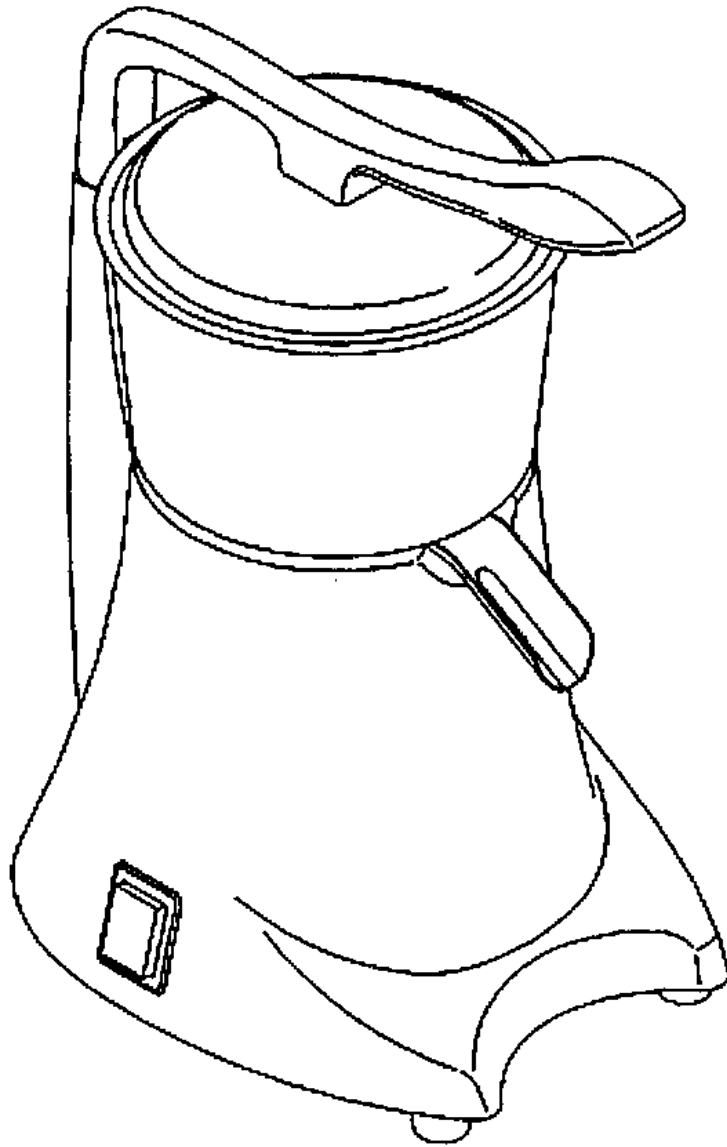

ESM4–Delta Citrus Juicer
Please read these instructions carefully.

IMPORTANT SAFEGUARDS

Before using the electrical appliance, the following precautions should always be followed:

1. Read all instructions, and save it for future reference.
2. Before use, check if the voltage of wall outlet corresponds to the one shown on the rating plate.
3. Unplug from the outlet when not in use, before putting on or taking off parts, and before cleaning. Clean motor housing with wet cloth, and wipe dry. Don't dip in water for rinse.
4. The instrument is not intended to be used by the disabled, with mental aberration or without related experiences and knowledge (including children), except they are supervised and directed by persons who are responsible for their safety to use the product.
5. Close supervision is necessary for any appliance being used by or near children.
6. Do not operate any appliance with a damaged supply cord or plug or after the appliance malfunctions, or is dropped or damaged in any manner. Return the appliance to the nearest authorized service facility for examination, repair, or electrical or mechanical adjustment.
7. Don't let supply cord hang over edge of table or worktop, or touch hot surface.
8. If the supply cord is damaged, it must be replaced by the manufacturer or its service agent or a similarly qualified person in order to avoid hazards.
9. Don't use the appliance if the rotating cone is damaged.
10. Switch off the appliance before changing accessories or approaching parts.
11. Keep hands, hair, clothing, as well as scraper and other utensils away from juicer during operation to reduce the risk of injury, and damage to the juicer.

BEFORE USE

1. Read all instructions.
2. Check the voltage of your juicer before plugging it in. Before plugging in, ensure switch is off.
3. Wash all parts and components that contact with juice. Rinse them under water and cool for dry.

HOW TO OPERATE

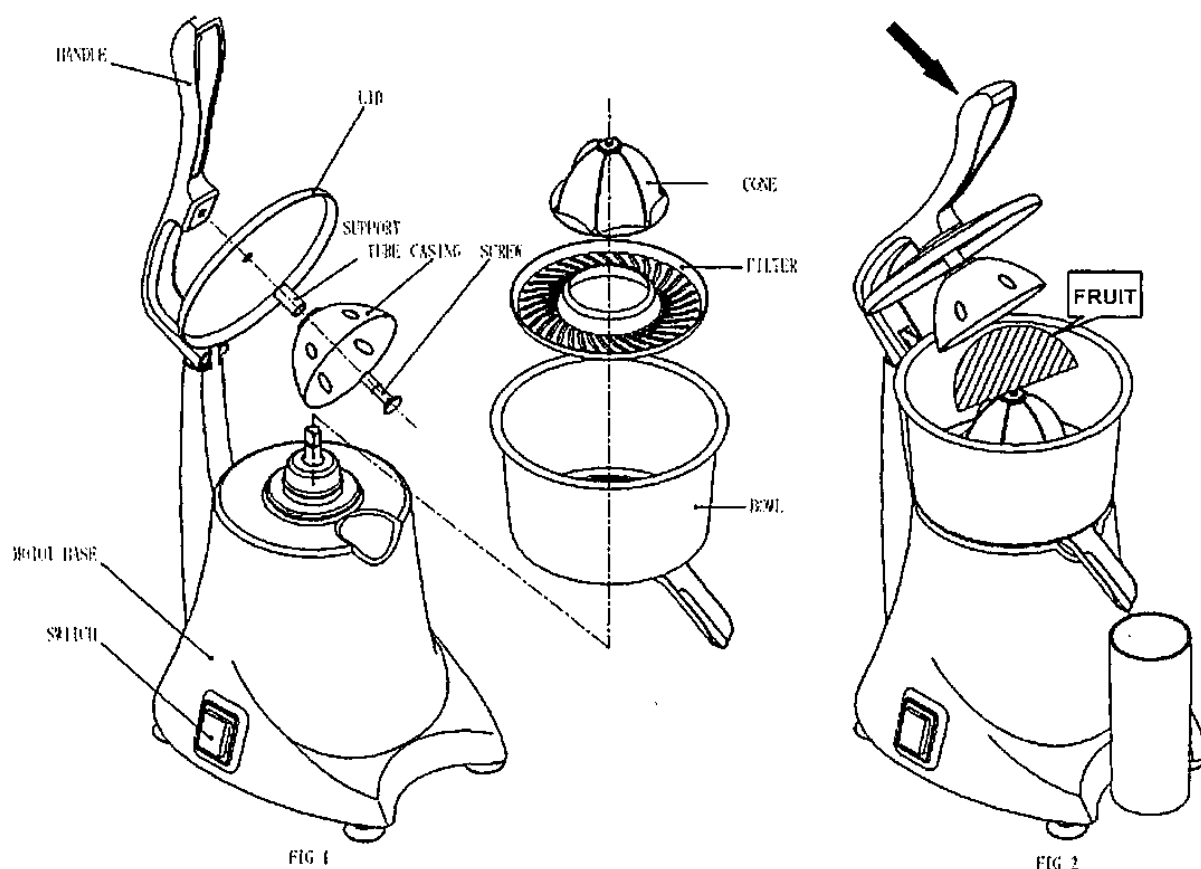

1. Cut the fruit in half.
 2. Put a cup under the spout.
 3. Plug in the socket. Switch to the position of "1". Align the center of cut orange with the top of juicer head and put it down. Press handle to make juicer head rotate. Impose even pressure until juice is flowing out (see Fig 2). Then take out the peel and change another cut orange. Repeat above operation. Pay attention to clean pumice in the filter to avoid overflow of pumice.
 4. Switch to the position of "0" when stop using it. Pull out the plug.
- Don't press too tight. If you hear the motor rotating slowly or it stops, you are pressing too tight. The motor will not become damaged because the thermal protective device turns the motor off if overstrained. If this occurs, we advise you to turn the juicer off with the on/off switch. After a few minutes, the motor will cool off and the juicer can be used again. Always switch the juicer off after use.

CLEANING

Never use steel wool abrasive cleaning ball or erosive liquid (such as alcohol, gasoline or acetone) to clean the product.

1. Always switch off the motor and unplug the juicer.
2. Never immerse the motor housing in water, wipe with a damp cloth to clean it and wipe dry.
3. It is easy to detach all parts and components contact with juice rapidly, such as juicer head, filter, juice bowl and other apparatuses. Bowl pressing assembly shall be detached in counterclockwise direction holding the handle. It is quite sharp on the bowl edge; please pay more attention to avoid scratches to your hands. When assembling the bowl pressing assembly, note to ensure the bowl is always contacting with the bench. Screw up in clockwise direction.
4. Rinse all parts coming into contact with the juice immediately after use.
5. Take care to wash all parts in contact with the juice before using the appliance for the first time.

SPECIFICATIONS

Power supply 50/60Hz

Dimensions(L×W×H) 28.7×21.2×39.6cm

Manufacturer:

Guangzhou Sunmile Electrical & Mechanical Manufacturing Corp.,Ltd.

Address:

No. 8, Yunzhan Rd., Yunpu Industrial Zone, Luogang District,
Guangzhou City, Guangdong, P.R.China.

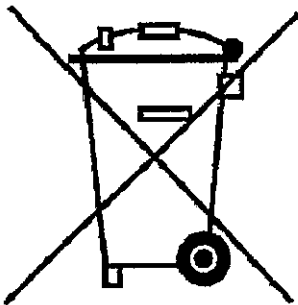

DISPOSAL:

Do not dispose this product as unsorted municipal waste. Collection of such waste separately for special treatment is necessary.

