

XL

Passthrough Dishwasher

STARLINE

by **WASHTECH**



STANDARD FEATURES

40, 60, and 90 second cycles
1.5HP wash pump
Washtech hybrid controls
Dual chemical pumps
Drain pump
Heavy-duty stainless steel construction and manifold
Independent stainless steel wash and rinse arms
Two-stage stainless steel filtration

2x 500mm dish rack (600 70028)
1x 500mm cup rack (600 70029)
1x cutlery basket (C660508)
1x cutlery container (C660503)

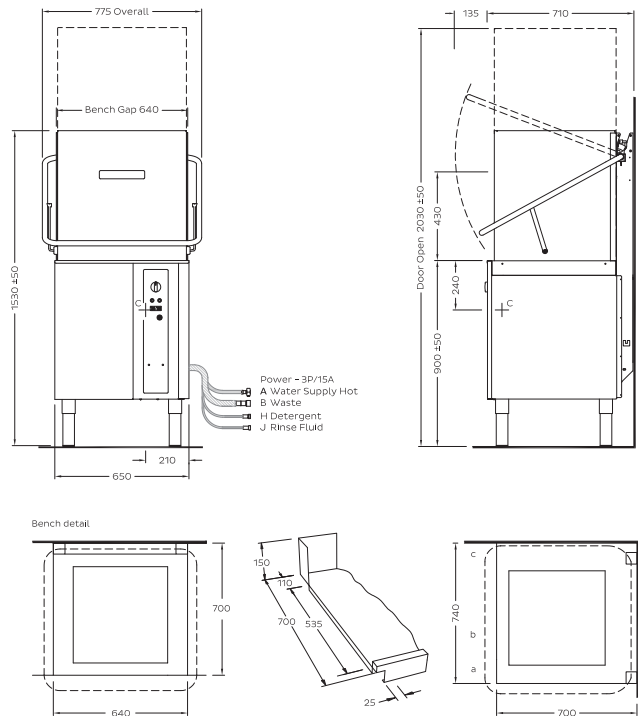

SPECIFICATIONS

A - Hot Water

Temperature	65°C
Connection	3/4" male, hose supplied
Pressure	200-350kPa
Flow	20L per minute
Backflow prevention	Atmospheric vacuum breaker
Consumption	2.6L per cycle*

D - Drainage

Drain pump flexi-hose	25mm
-----------------------	------

C - Electrical

V	Hz	A/ph	Max kW	
Three phase	400	50	15	10.80
Single phase	240	50	15	6.10
Single phase	240	50	25	3.10

Dimensions

	Machine	Packed
Width (mm)	775	790
Depth (mm)	710	950
Height (mm)	1530	1470
Weight (kg)	120	141
Volume (m3)		0.92

Water Quality

	Min	Max
pH	7	8
Hardness	20	100
Cl-		100
SO4		400
Fe		0.1
Mn		0.5
Cu		0.05
Cl2		0.1

*Water consumption rates may vary based on site conditions
Isolating switch must be within 1m of, and not directly behind, the machine
Refer to operator manual for installation instructions

In line with policy to continually develop and improve its products,
Washtech reserves the right to change specifications and design without
notice.

Corner Installation Notes:

- a. Machine must face left for easy access to the controls
- b. Allow 300mm clearance to front for service access
- c. Splashback return to be no higher than 150mm