

INSTRUCTION SHEET 239552 FOR FITTING DOUBLE STACKING KIT DSKE32 / DSKE32C TO E32D / E32T OVENS



SERVICE WORK ONLY TO BE CARRIED OUT BY QUALIFIED PERSONS

Suitable for the following models:

Turbofan E32D / E32T Ovens.

Packed By: -	
Initial	Date

Contents: Double Stacking Kit DSKE32 / DSKE32C.
Required: Food Grade RTV Silicone Sealant (not supplied with Kit).

Unpacking and Assembly:

Check that the kit includes the correct parts and quantities for the stand as listed overleaf.

1. Assemble Base Stand:

- Remove protective plastic from 2 stand sides.
- Assemble stand sides to front frame (with rail) and rear frame, secure with screws supplied.
- For DSK32C Stands** - Fit spring washer (17) to threaded shaft of all castors and screw castors into front and rear frames, securely tighten using 22mm A/F Spanner.

NOTE Always fit Braked Castors to front frame, which is fitted with guard rail.

DSKE32C fitted with Castors

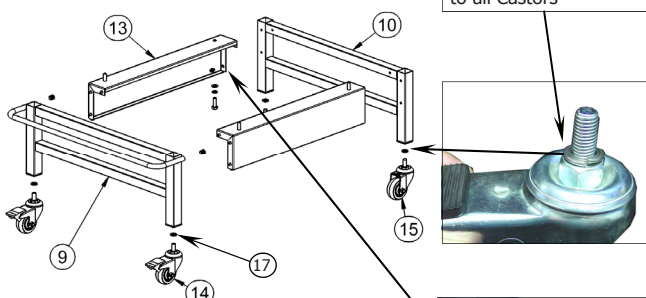

DSKE32 Fitted with Adjustable Feet

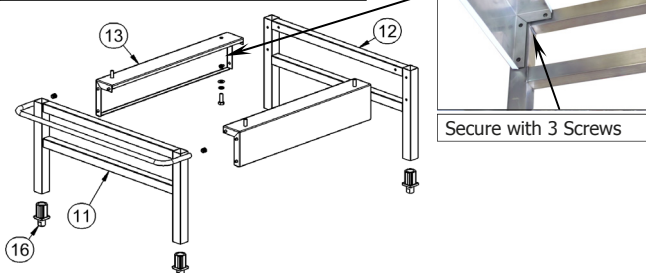

2. Assemble Oven to Base Stand:

- Remove feet from oven.
- Lift oven onto base stand with front of oven at same side as protective guard rail.

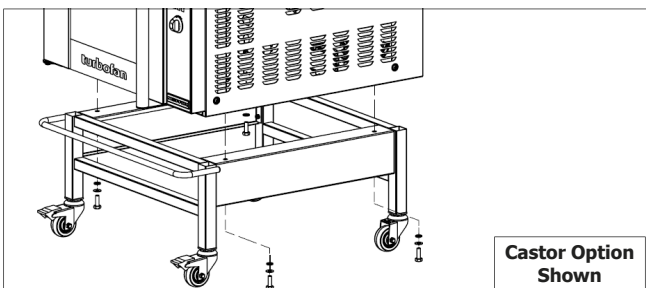

- Align 4 holes in base stand side rails with holes in oven base panel and secure using spring washer, flat washer and M10 Hex bolt.

3. Fit Spacer Assy to Bottom Oven:

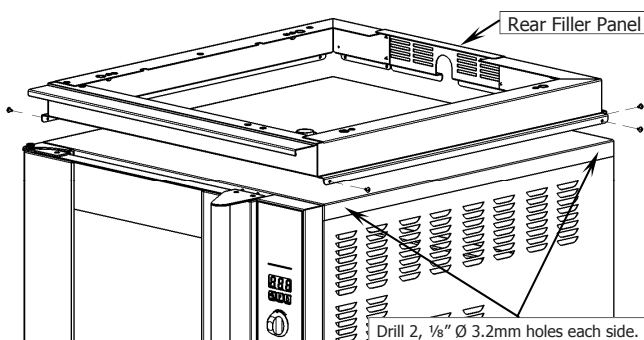

- Remove protective plastic from spacer assembly.
- Place spacer assembly on top of oven and secure spacer assembly to oven.
- If holes not present, drill 4 $\frac{1}{8}$ " - \varnothing 3.2mm holes in rear panel.
- Drill 2, $\frac{1}{8}$ " - \varnothing 3.2mm holes in each side and secure with screws supplied.
- Remove rear filler.
- Fit oven vent tube to lower oven and drill 2, $\frac{1}{8}$ " - \varnothing 3.2mm holes.
- Remove oven vent tube and smear tube flange with Food Grade RTV Silicone Sealant (not supplied).
- Refit and secure oven vent tube with screws supplied.
- Refit rear filler.

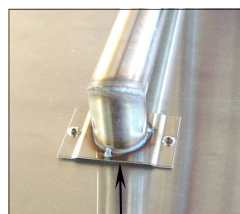

Smear flange with RTV Silicone Sealant prior to fitting Vent Tube.

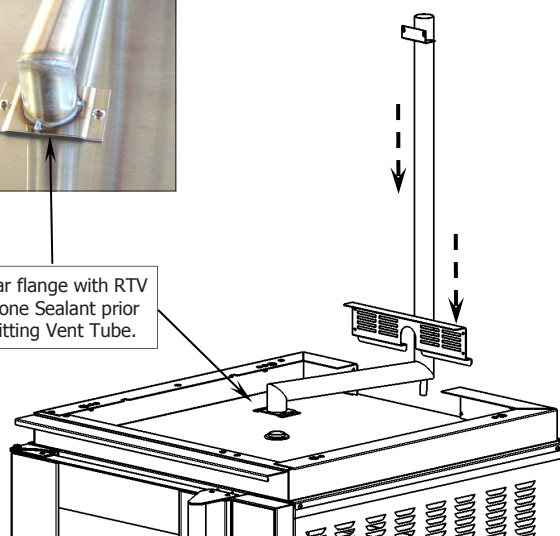

Instruction Sheet 239552 for fitting Double Stacking Kit DSKE32 / DSKE32C to E32D / E32T Ovens

4. Fit Top Oven to Bottom Oven:

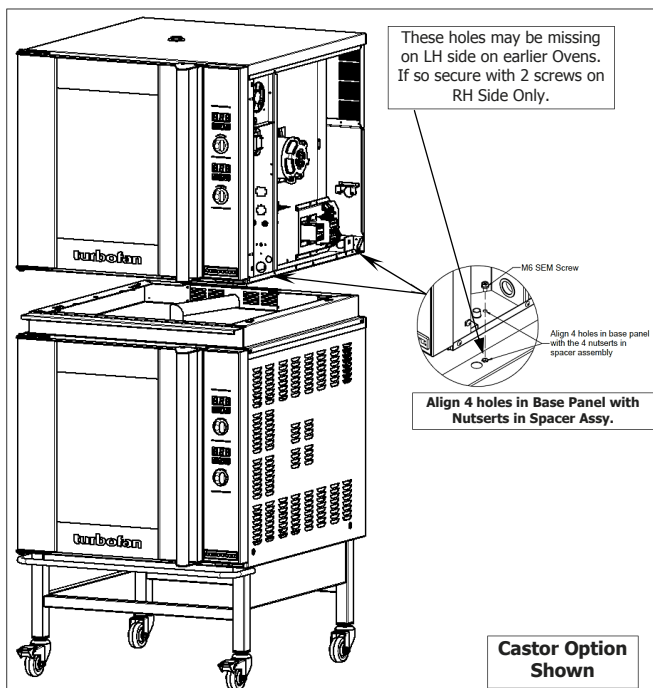

- Remove the feet from upper oven.
- Remove LH and RH side panels from upper oven.
- Lift upper oven onto spacer frame.
- Align holes in upper oven base panel with holes in spacer frame and secure with 2 or 4, M6 screws. **Remove LH side panel bracket (2 screws) and move insulation to allow access to front LH screw hole. Refit bracket on completion of oven fit.**

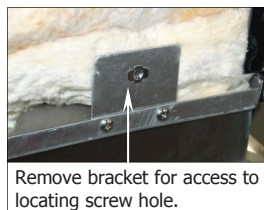

NOTE On earlier ovens, no securing holes provided on LH side of oven. Oven to be secured with the 2 screws on RH Side Only.

- Refit LH and RH side panels.
- Secure vent tube to upper oven using 2 screws supplied in kit (earlier ovens may not have holes provided - drill 2 holes $\frac{1}{8}$ " - \varnothing 3.2mm in top panel, using vent tube as a guide).

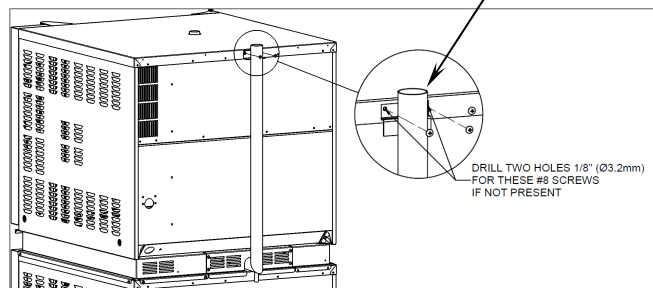
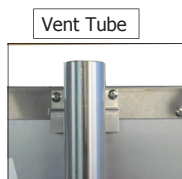

- Centre drain tube bracket on stand, drill 2 holes $\frac{1}{8}$ " (3.2mm) and secure with 2 screws.

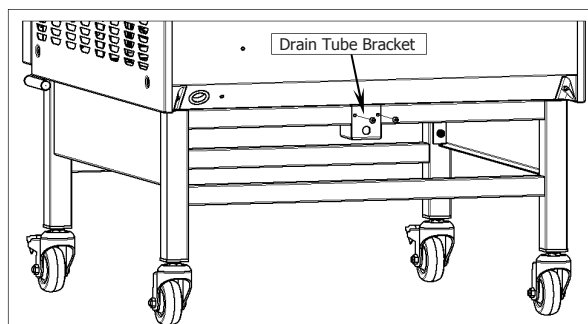

- Rotate drain tube through 90° to fit through drain tube bracket. Rotate back to vertical once in position.

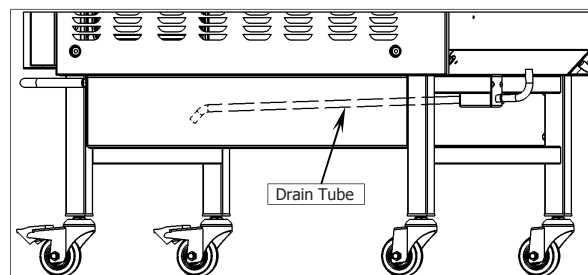

- Fit the drain hose and secure with hose clamps.

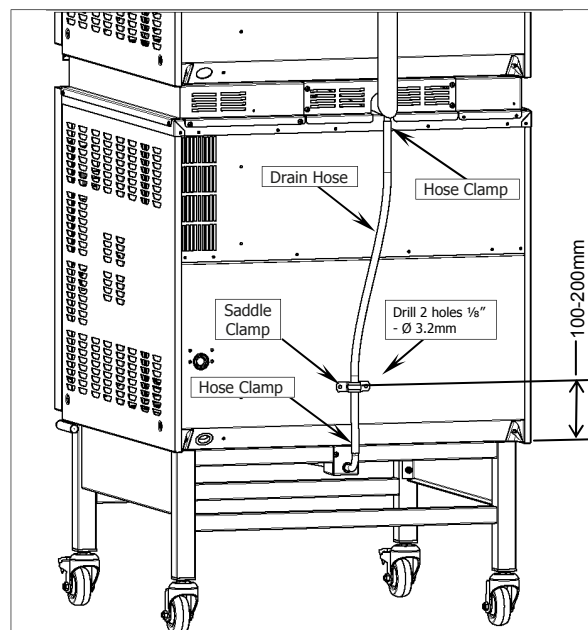

- Drill 2 holes $\frac{1}{8}$ " - \varnothing 3.2mm in approximate area shown above and fit saddle clamp with 2 screws supplied.
- Fit condensate tray to front rail of base stand.

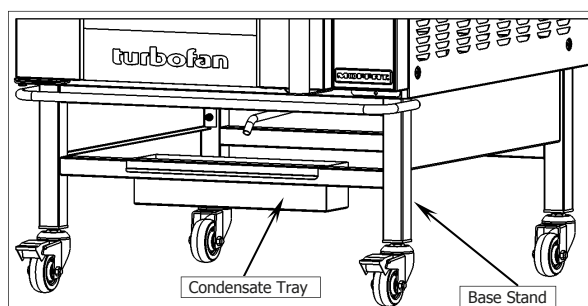

NOTE: On completion of assembly, ensure that all screws are securely tightened.

Parts List:

Spacer Frame Assembly

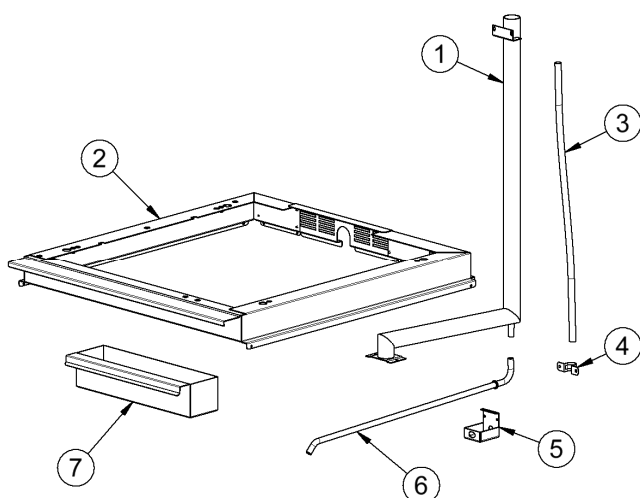

Item No.	Part No.	Item	Qty
Spacer Frame Assembly			
1	239550	Vent Tube DSKE32	1
2	235018	Spacer Frame DSKE32	1
3	239574	Drain Hose PVC 1/2" x 700MM	1
4	011153	Saddle Clamp 1/2" GALV	1
5	239483	Drain Tube Bracket	1
6	239481	Drain Tube	1
7	239490	Condensate Tray	1
8	239573	Hose Clamp (Not shown)	2
DSKE32C - fitted with Castors			
9	235014	Front Frame (Castor Models)	1
10	235015	Rear Frame (Castor Models)	1
13	234966	Stand Side	2
14	234213	Castor 3" Stem Swivel D-Brake (DSKE32C Only)	2
15	234212	Castor 3" Stem Swivel (DSKE32C Only)	2
17	045430	Washer M12 Spring (DSKE32C Only)	4
DSKE32 - fitted with Adjustable Feet			
11	234953	Front Frame (Adjustable Feet Models)	1
12	234956	Rear Frame (Adjustable Feet Models)	1
16	021211	Adjustable Foot 38mm (Fitted on DSKE32 Only)	4
Parts not Shown			
18	041045	Screw 8 x 3/8" Truss Philips N/P - (Not shown)	18
19	748039	Screw M6 x 12 Hex HD POZI ZP - (Not shown)	16
20	041670	Screw M10 x 30 Hex HD ZP - (Not shown)	4
21	748050	Washer M10 Spring ZP - (Not shown)	4
22	045060	Washer M10 Flat ZP - (Not shown)	4

DSKE32C - fitted with Castors

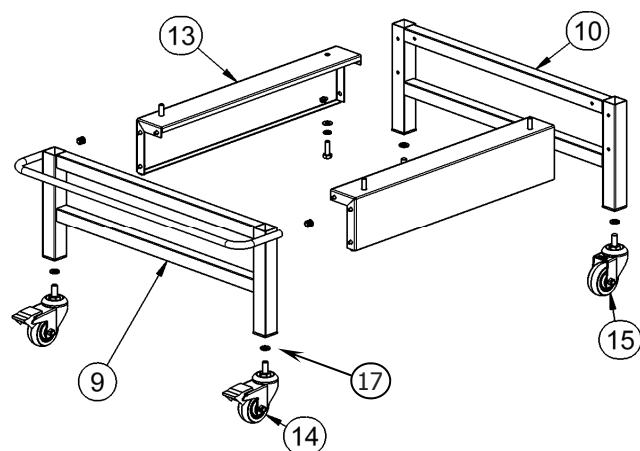

DSKE32 - fitted with Adjustable Feet

