



Cold Tower and Floor Standing Display Cabinets

ERE21, ERE22, ERE23, ERE25



ERE21

ERE22



ERE23

ERE25

Introducing a classy range of display cabinets from EuroChill. Solid stainless steel body, nicely finished with LED lighting and a bold black frame to accentuate your food display. Double glazing and heated glass on the floorstanding models help to prevent condensation in our humid climate. Choose from our stylish range of floorstanding and benchtop options.

OTHER FEATURES

- Digital temperature controller and display
- Adjustable chrome plated shelves
- 4 castors with 2 brakes on floorstanding models
- On/off switch
- Ventilated cooling system and automatic defrost
- Internal LED illumination on sides
- Stainless steel body
- Coated evaporators

Code	ERE22	ERE25	ERE23	ERE21
Gross capacity (L)	78	410	300	400
Temperature range (°C)	0-12	2-8	2-8	0-10
Rated input power (W)	180	580	575	420
Power consumption (kWh/day)	2.890	6.1	5.1	5.833
Rated current (A)	1.2	2.8A	2.75A	1.46
Rated frequency (Hz)	50	50Hz	50Hz	50
Rated voltage (V)	220-240	220-240	220-240	220-240
Glass	Double glazed	Double glazed	Double glazed	Triple glazed
Refrigerant	R134a	R134a	R290a	R290a
Lamp power (W)	1.44*4(LED)	15(LED)	15(LED)	1.5*4(LED)
Type of climate	4	4	4	4
Dimensions (mm)	430W x 390D x 986H	1215W x 685D x 1410H	915W x 685D x 1410H	650W x 650D x 1980H
Net weight (kg)	42	155	135	175

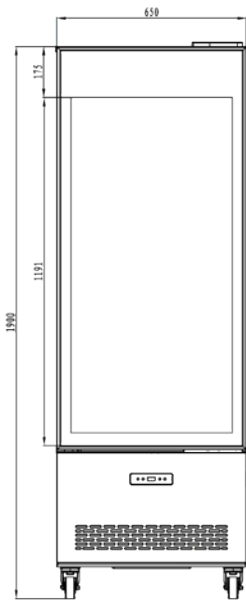

ERE21 Front

ERE21, ERE22

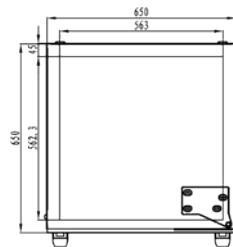

ERE21 Footprint

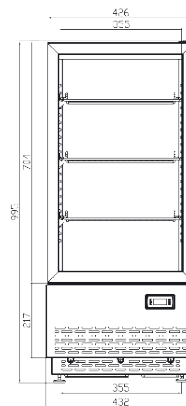

ERE22 Front

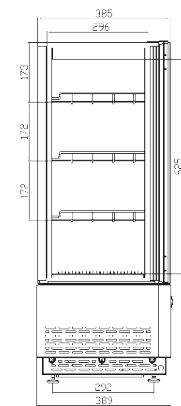

ERE22 Side

Sufficient ventilation required. See EuroChill warranty document for more information.
 **1 year warranty applies for off shore New Zealand and Australia.

- Subject to correct use and maintenance. Specifications are subject to change without notice

ERE23, ERE25

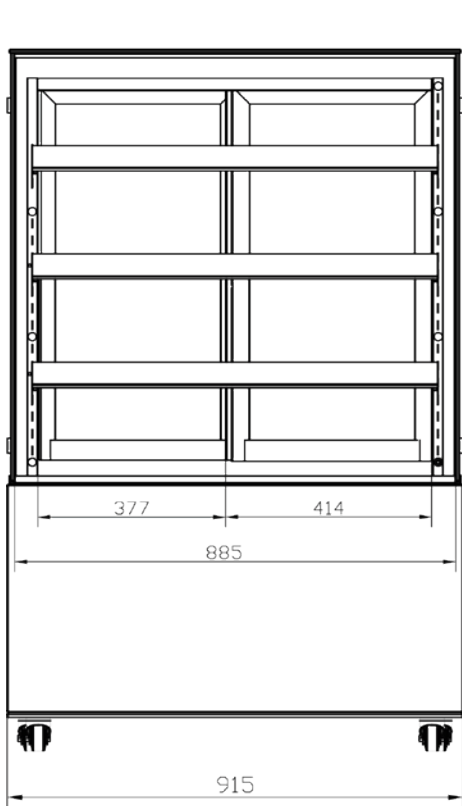

ERE23 Front

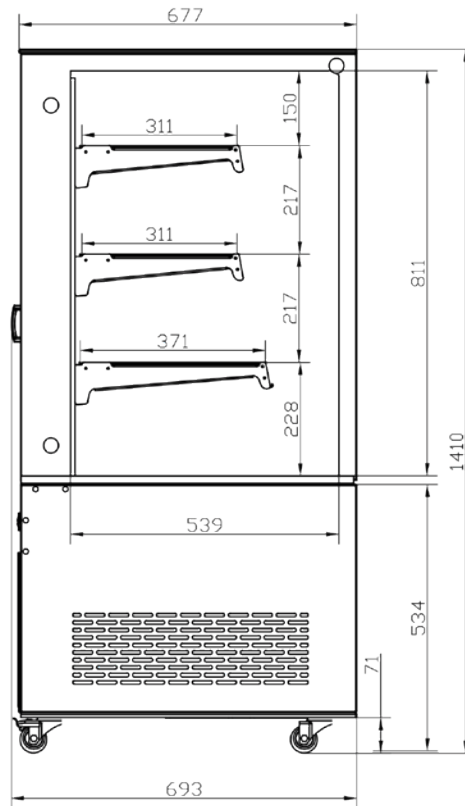

ERE23 Side

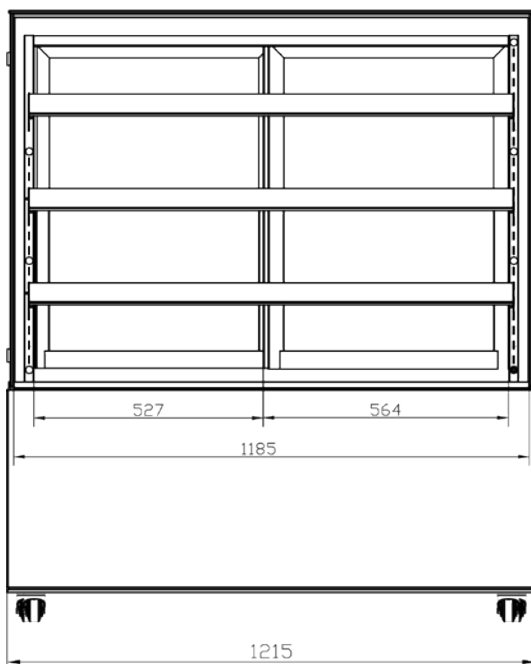

ERE25 Front

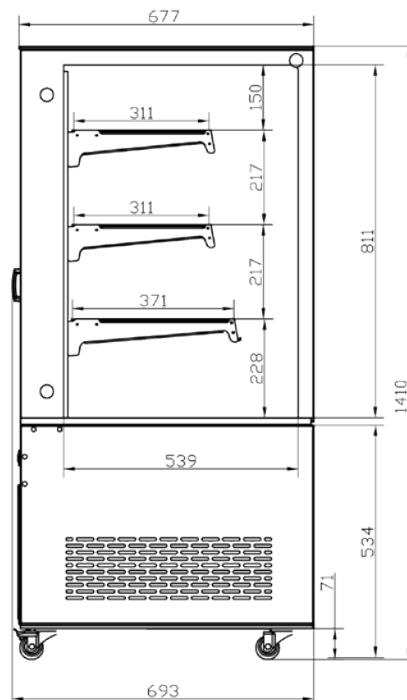

ERE25 Side